

Licensing Act 2003 Sub-Committee on 4TH JULY 2006

Report title: Application to Vary a Premises Licence for Yayla Restaurant, 429 Green Lanes, London, N4 1HA

Report of: The Lead Officer Licensing

Ward(s) affected Seven Sisters

1. Purpose

To consider an application by **HAYRETTIN KACMAZ** to vary a New Premises Licence

2. Recommendations

- 2.1 (a) Grant the application as asked
(b) Modify the conditions of the licence, by altering or omitting or adding to them
(c) Reject the whole or part of the application

The Committee is asked to note that it may not modify the conditions or reject the whole or part of the application unless it is necessary to promote the licensing objectives.

Report authorised by: Robin Payne.....

Assistant Director Enforcement Services

Contact Officer: Ms Daliah Barrett

Telephone: 020 8489 5103

3. Executive summary

For consideration by Sub Committee under Licensing Act 2003 for a Variation to a New Premises Licence

4. Access to information:

Local Government (Access to Information) Act 1985
Background Papers

The following Background Papers are used in the preparation of this Report:

File: YAYLA RESTAURANT, 429 GREEN LANES, LONDON, N4 1HA

The Background Papers are located at Enforcement Service, Civic Centre, High Road Wood Green N22

5. REPORT

Background

5.1 Application by **HAYRETTIN KACMAZ**, for a Variation to a New Premises Licence in respect of **YAYLA RESTAURANT, 429 GREEN LANES, LONDON, N4 1HA** under the Licensing Act 2003.

5.2 Details of Variation to a new Premises Licence application – APP 1

Opening Hours for Public

Monday to Sunday

08.00 – 02.00

5.2 Crime and Disorder

The applicant will take all reasonable steps to ensure that crime and /or disorder does not occur on the premises.

5.4 Public Safety

Appropriate fire safety procedures are in place.

5.5 Public Nuisance

All customers are asked to respect neighbours and leave quietly. Clear and legible notices will be prominently displayed requesting customers to leave quietly

5.6 Child Protection

Restriction under the Licensing act 2003 will apply

If in doubt, the licensee and staff will ask persons who appear to be under age of 18 for photographic ID such as proof of age cards, the connexions card and Citizen Card, photographic driving licence or passport, an official identity card issued by HM Forces or by and EU county, bearing the photograph and date of birth bearer

The applicant is happy to participate in any 'Challenge 21' or 'Think 21' or similar scheme if exits in the area.

6. RELEVANT REPRESENTATIONS (CONSULTATION)

Responsible authorities:

6.1 Comments of Metropolitan Police

The Police have no comments to make.

6.2 Comments of Enforcement Services:

Noise team has made no representation.

Food Team

Have no objections to this application

Health and Safety

Have no objections to this application

Trading Standards

Have no objections to this application

6.3 Fire Officer

The Fire Officer has no objections to this application.

6.4 Planning Officer – App 2

Planning has the following objections to this application.

Reason for objection is based on the following condition of consent (HGY/2000/0612) granted on the 27th February 2000 for a Change of Use of Ground floor from Unit (A1) to (A3) Restaurant.

The use hereby permitted shall not be operated before 8.00 or after 23.30 hours on any day. – This permission is given to facilitate the beneficial use of the premises whilst ensuring that the amenities of adjacent residential properties are not diminished.

And

Permission (Ref. HGY/2005/0064) has been granted as an extension of opening hours on 8th March 2005 for premises to only open from:

09.00 am to 12.00 midnight on Sundays to Thursdays and 10.00 am to 02.00 am on Friday and Saturdays.

6.5 Comments of Child Protection Agency or Nominee

Proof of age scheme to be adhered to

7.0 Interested Parties

2 letters of representation have been received against this application.
App 3

8.0 Financial Comments

The fee which would be applicable for this application was **£190.00**

APP 1

APPLICATION FORM



2005-2006
Getting Closer to Communities



INVESTOR IN PEOPLE

Book 80
 CHA 190
 AG 793000

Application to vary a premises licence under the Licensing Act 2003

PLEASE READ THE FOLLOWING INSTRUCTIONS FIRST

Before completing this form please read the guidance notes at the end of the form.
 If you are completing this form by hand please write legibly in block capitals. In all cases ensure that your answers are inside the boxes and written in black ink. Use additional sheets if necessary.
 You may wish to keep a copy of the completed form for your records.

I/We HAYRETTIN KACMAZ
(Insert name(s) of applicant)

being the premises licence holder, apply to vary a premises licence under section 34 of the Licensing Act 2003 for the premises described in Part 1 below

Premises licence number LN/00001598

Part 1 – Premises Details

Postal address of premises or, if none, ordnance survey map reference or description YAYLA RESTAURANT 429 GREEN LANES			
Post town	LONDON	Post code	N4 1HA

Telephone number at premises (if any)	020 8348 9515
Non-domestic rateable value of premises	£12500

Part 2 – Applicant details

Daytime contact telephone number	
E-mail address (optional)	
Current postal address if different from premises address	
Post Town	Postcode

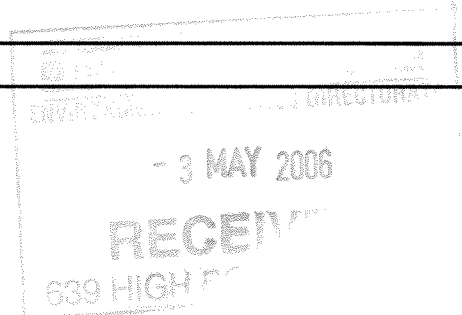

Part 4 Operating Schedule

Please complete those parts of the Operating Schedule below which would be subject to change if this application to vary is successful.

Provision of regulated entertainment

Please tick yes

- a) plays (if ticking yes, fill in box A)
- b) films (if ticking yes, fill in box B)
- c) indoor sporting events (if ticking yes, fill in box C)
- d) boxing or wrestling entertainment (if ticking yes, fill in box D)
- e) live music (if ticking yes, fill in box E)
- f) recorded music (if ticking yes, fill in box F)
- g) performances of dance (if ticking yes, fill in box G)
- h) anything of a similar description to that falling within (e), (f) or (g) (if ticking yes, fill in box H)

Provision of entertainment facilities:

- i) making music (if ticking yes, fill in box I)
- j) dancing (if ticking yes, fill in box J)
- k) entertainment of a similar description to that falling within (i) or (j) (if ticking yes, fill in box K)

Provision of late night refreshment (if ticking yes, fill in box L)

Sale by retail of alcohol (if ticking yes, fill in box M)

In all cases complete boxes N, O and P

B

Films Standard days and timings (please read guidance note 6)			Will the exhibition of films take place indoors or outdoors or both – please tick (please read guidance note 2)	Indoors	<input type="checkbox"/>
				Outdoors	<input type="checkbox"/>
				Both	<input type="checkbox"/>
Day	Start	Finish	Please give further details here (please read guidance note 3)		
Mon					
Tue			State any seasonal variations for the exhibition of films (please read guidance note 4)		
Wed					
Thur			Non standard timings. Where you intend to use the premises for the exhibition of films at different times to those listed in the column on the left, please list (please read guidance note 5)		
Fri					
Sat					
Sun					

N/A

D

Boxing or wrestling entertainments Standard days and timings (please read guidance note 6)			Will the boxing or wrestling entertainment take place indoors or outdoors or both – please tick (please read guidance note 2)	Indoors <input checked="" type="checkbox"/>
				Outdoors <input type="checkbox"/>
				Both <input type="checkbox"/>
Day	Start	Finish	Please give further details here (please read guidance note 3)	
Mon				
Tue				
Wed			State any seasonal variations for boxing or wrestling entertainment (please read guidance note 4)	
Thur			N/A	
Fri			Non standard timings. Where you intend to use the premises for boxing or wrestling entertainment at different times to those listed in the column on the left, please list (please read guidance note 5)	
Sat				
Sun				

F

Recorded music Standard days and timings (please read guidance note 6)			<u>Will the playing of recorded music take place indoors or outdoors or both – please tick</u> (please read guidance note 2)	Indoors	<input type="checkbox"/>
				Outdoors	<input type="checkbox"/>
				Both	<input type="checkbox"/>
Day	Start	Finish	<u>Please give further details here</u> (please read guidance note 3)		
Mon					
Tue					
Wed			<u>State any seasonal variations for the playing of recorded music</u> (please read guidance note 4) N/A		
Thur					
Fri			<u>Non standard timings. Where you intend to use the premises for the playing of recorded music at different times to those listed in the column on the left, please list</u> (please read guidance note 5)		
Sat					
Sun					

H

<p>Anything of a similar description to that falling within (e), (f) or (g) Standard days and timings (please read guidance note 6)</p>			<p><u>Please give a description of the type of entertainment you will be providing</u></p>		
Day	Start	Finish	<p><u>Will this entertainment take place indoors or outdoors or both – please tick</u> (please read guidance note 2)</p>	Indoors	<input type="checkbox"/>
Mon				Outdoors	<input type="checkbox"/>
				Both	<input type="checkbox"/>
Tue			<p><u>Please give further details here</u> (please read guidance note 3)</p>		
Wed					
Thur			<p><u>State any seasonal variations for entertainment of a similar description to that falling within (e), (f) or (g)</u> (please read guidance note 4)</p> <p style="text-align: center;">N/A</p>		
Fri					
Sat			<p><u>Non standard timings. Where you intend to use the premises for the entertainment of a similar description to that falling within (e), (f) or (g) at different times to those listed in the column on the left, please list</u> (please read guidance note 5)</p>		
Sun					

J

Provision of facilities for dancing Standard days and timings (please read guidance note 6)			Will the facilities for dancing be indoors or outdoors or both – please tick (see guidance note 2)	Indoors <input type="checkbox"/>
				Outdoors <input type="checkbox"/>
				Both <input type="checkbox"/>
Day	Start	Finish	<u>Please give a description of the facilities for dancing you will be providing</u>	
Mon			<u>Please give further details here</u> (please read guidance note 3)	
Tue				
Wed				
Thur			<u>State any seasonal variations for providing dancing facilities</u> (please read guidance note 4)	
			N/A	
Fri			<u>Non standard timings. Where you intend to use the premises for the provision of facilities for dancing at different times to those listed in the column on the left, please list</u> (please read guidance note 5)	
Sat				
Sun				

L

Late night refreshment Standard days and timings (please read guidance note 6)			Will the provision of late night refreshment take place indoors or outdoors or both – please tick (please read guidance note 2)	Indoors	<input checked="" type="checkbox"/>
				Outdoors	<input type="checkbox"/>
				Both	<input type="checkbox"/>
Day	Start	Finish	Please give further details here (please read guidance note 3)		
Mon	23:00	02:00			
Tue	23:00	02:00			
			State any seasonal variations for the provision of late night refreshment (please read guidance note 4)		
Wed	23:00	02:00			
Thur	23:00	02:00			
			Non standard timings. Where you intend to use the premises for the provision of late night refreshment at different times, to those listed in the column on the left, please list (please read guidance note 5)		
Fri	23:00	04:00			
Sat	23:00	04:00			
Sun	23:00	02:00			

O

Hours premises are open to the public Standard days and timings (please read guidance note 6)			State any seasonal variations (please read guidance note 4) N/A
Day	Start	Finish	
Mon	08:00	02:00	
Tue	08:00	02:00	
Wed	08:00	02:00	
Thur	08:00	02:00	
			Non standard timings. Where you intend the premises to be open to the public at different times from those listed in the column on the left, please list (please read guidance note 5) N/A
Fri	08:00	04:00	
Sat	08:00	04:00	
Sun	08:00	02:00	

Please identify those conditions currently imposed on the licence which you believe could be removed as a consequence of the proposed variation you are seeking
Restriction on operating hours in relation to Fridays and Saturdays only.

P Describe any additional steps you intend to take to promote the four licensing objectives as a result of the proposed variation:

a) General – all four licensing objectives (b,c,d,e) (please read guidance note 9)

The licensee has run the premises for a number of years, and now seeks to vary the premises licence both to enhance his business and continue to provide a local amenity for nearby residents.

The following are proposed as conditions in addition to those already on the existing premises licence.

b) The prevention of crime and disorder

The licensee will report all incidences of a criminal nature that may occur on the premises to the Police.

No less than two members of staff will be on the shop floor of the premises between the hours of 23:00 and 07:00.

c) Public safety

Appropriate fire safety procedures are in place and shall be maintained at all times including fire extinguishers (H₂O, CO₂), illuminated fire exit signs, smoke detectors and emergency lighting.

d) The prevention of public nuisance

The licensee shall display clear and prominent notices requesting customers not to congregate outside the premises.

e) The protection of children from harm

Variation proposes no new risks.





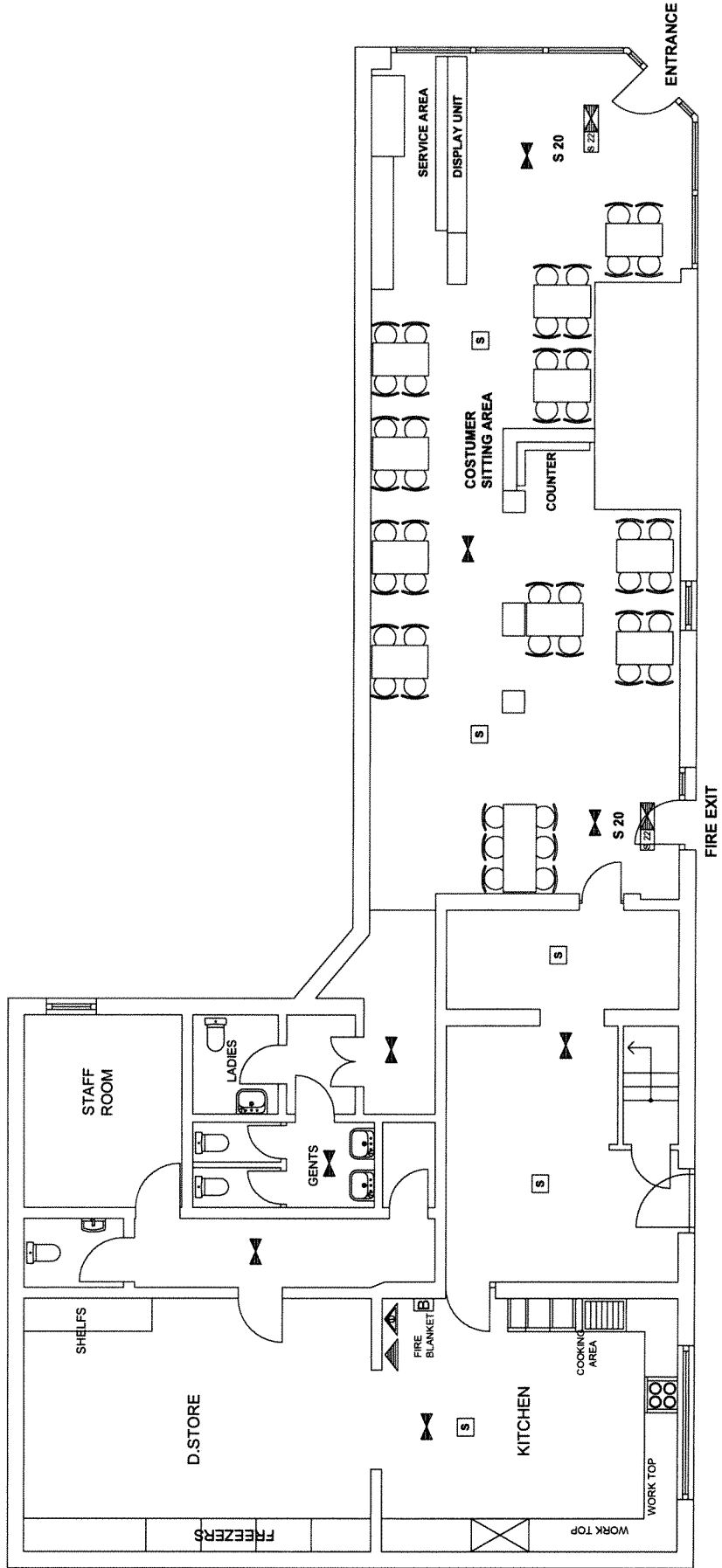

Notes for Guidance

This application cannot be used to vary the licence so as to extend the period for which the licence has effect or to vary substantially the premises to which it relates. If you wish to make that type of change to the premises licence you should make a new premises licence application under section 17 of the Licensing Act 2003.

1. Describe the premises. For example the type of premises, its general situation and layout and any other information which could be relevant to the licensing objectives. Where your application includes off-supplies of alcohol and you intend to provide a place for consumption of these off-supplies you must include a description of where the place will be and its proximity to the premises.
2. Where taking place in a building or other structure please tick as appropriate. Indoors may include a tent.
3. For example state type of activity to be authorised, if not already stated, and give relevant further details, for example (but not exclusively) whether or not music will be amplified or unamplified.
4. For example (but not exclusively), where the activity will occur on additional days during the summer months.
5. For example (but not exclusively), where you wish the activity to go on longer on a particular day e.g. Christmas Eve.
6. Please give timings in 24 hour clock (e.g. 16:00) and only give details for the days of the week when you intend the premises to be used for the activity.
7. If you wish people to be able to consume alcohol on the premises please tick on, if you wish people to be able to purchase alcohol to consume away from the premises please tick off. If you wish people to be able to do both please tick both.
8. Please give information about anything intended to occur at the premises or ancillary to the use of the premises which may give rise to concern in respect of children regardless of whether you intend children to have access to the premises, for example (but not exclusively) nudity or semi-nudity, films for restricted age groups, the presence of gaming machines.
9. Please list here steps you will take to promote all four licensing objectives together.
10. The application form must be signed.
11. An applicant's agent (for example solicitor) may sign the form on their behalf provided that they have actual authority to do so.
12. Where there is more than one applicant, both applicants or their respective agents must sign the application form.
13. This is the address which we shall use to correspond with you about this application.



LEGEND

-  SAFETY LIGHTS
-  SMOKE DETECTOR
-  CARBON DIOXIDE FIRE EXTINGUISHER
-  9 LT. WATER FIRE EXTINGUISHER
-  FIRE ESCAPE KEEP CLEAR
-  INTERNALLY ILLUMINATED FIRE ESCAPE SIGN (BS 5266)

YAYLA RESTAURANT
 429 GREEN LANES
 HARINGEY
 LONDON
 N4 1HA

PROPOSED GROUND FLOOR PLAN

SCALE : 1/100 DATE : 21/07/05
 REF. NO : 4802164-01

276 HIGHBURY
 NEW PARK
 ISLINGTON
 LONDON - N5 2LH
 Tel : 020 7226 3313
 www.tsbao.org.uk



Part 2

Name, (registered) address, telephone number and e-mail (where relevant) of holder of Premises Licence:

Mr Hayrettin Kacmaz
C/o: YAYLA RESTAURANT
429 GREEN LANES
HARINGEY, LONDON
N4 1HA
Telephone: 020 8348 9515

Registered number of holder, for example company number, charity number (where applicable):

Name, address and telephone number of designated premises supervisor where the Premises Licence authorises the supply of alcohol:

Mr Hayrettin Kacmaz
C/o: YAYLA RESTAURANT
429 GREEN LANES
HARINGEY, LONDON
N4 1HA
Telephone: 020 8348 9515

Personal Licence number and issuing authority of personal licence held by designated premises supervisor where the Premises Licence authorises for the supply of alcohol:

N/A: Designated Premises Supervisor not permitted to sell alcohol.





Annex 1 –Mandatory Conditions





Annex 2 – Conditions consistent with the Operating Schedule

THE PREVENTION OF CRIME AND DISORDER

Customers will be asked to leave the premises quietly and a notice will be displayed accordingly.
Alcohol will not be served on the premises.

PUBLIC SAFETY

Appropriate fire safety procedures will be put in place, including fire extinguishers.
Premises will be suitably and sufficiently lit and maintained in any area accessible to the public.

THE PREVENTION OF PUBLIC NUISANCE

All ventilation and extract systems will be designed and maintained so as to prevent noxious smells causing a nuisance to nearby properties.

Refuse receptacles will be cleaned regularly with disinfectant.
Staff will undertake a regular litter pick up outside the premises.

THE PROTECTION OF CHILDREN

Alcohol will not be served on the premises.





Annex 3 – Conditions attached after a hearing by the licensing authority

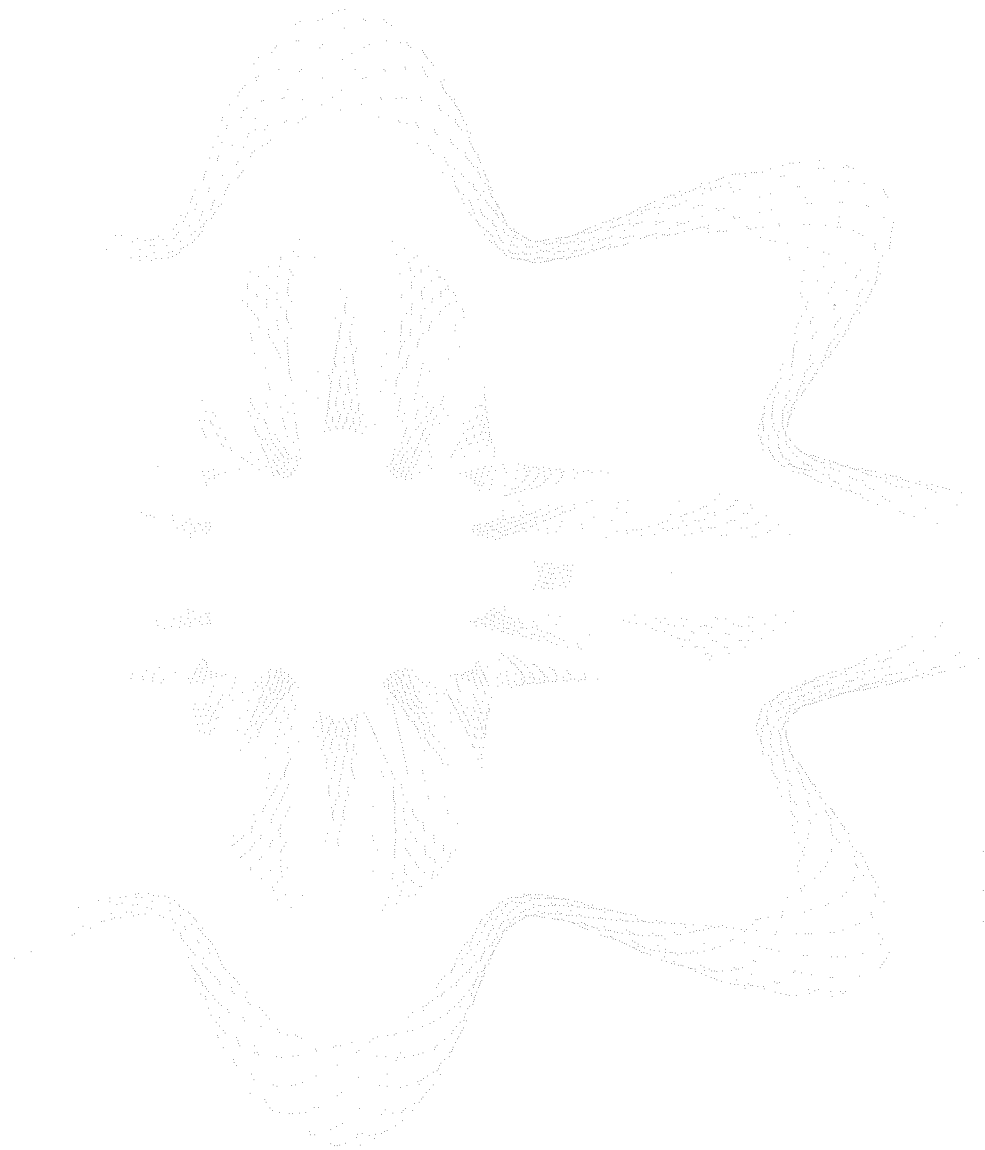



Annex 4 - Plans

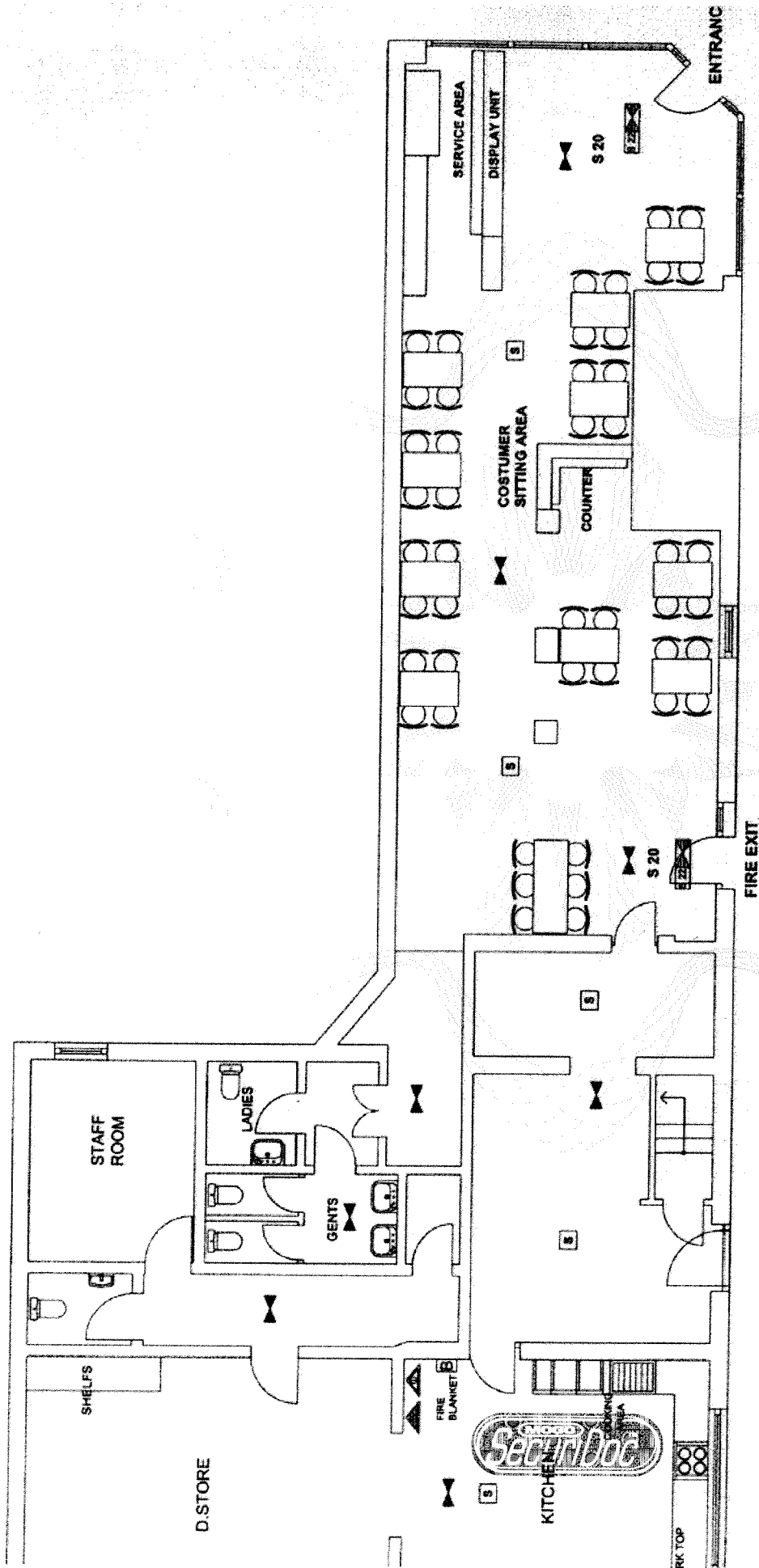

APP 2

PLANNING REPRESENTATION



2005-2006
Getting Closer to Communities



INVESTOR IN PEOPLE

Customer ID 353

Date Received 09 May 2006

Address 1 YAYLA RESTAURANT

Address 2 429 GREEN LANES

Address 3 LONDON

Post Code N4 1HA

Object

Approve

Conditions OBJECTION

REASON FOR OBJECTION IS BASED ON THE FOLLOWING
CONDITION OF CONSENT (HGY/2000/0612) GRANTED ON THE
27/02/2000 FOR A CHANGE OF USE OF GROUND FLOOR FROM
UNIT (A1) TO (A3) RESTAURANT:

2. The use hereby permitted shall not be operated before 8.00 or
after 23:30 hours on any day.
Reason: This permission is given to facilitate the beneficial use
of the premises whilst ensuring that the amenities of adjacent
residential properties are not diminished.

AND:

PERMISSION (REF. HGY/2005/0064) HAS BEEN GRANTED AS AN
EXTENSION OF OPENING HOURS ON 08/03/2005 FOR
PREMISES TO ONLY OPEN FROM:

09:00 AM TO 12:00 MIDNIGHT ON SUNDAYS TO THURSDAYS
AND 10:00 AM TO 02:00 AM ON FRIDAYS AND SATURDAYS.

Type of Licence

Notes It would be prudent for the applicant to make a new application
requesting a Variation of Condition requesting the hours of operations
be extended.

Email Date Sent 19-May-06

APP 3

RESIDENTS REPRESENTATIONS



2005-2006
Getting Closer to Communities



INVESTOR IN PEOPLE

Received
30/5/06
OB

Karen J Alexander
139 Wightman Road
London N8 0BB
020 8348 5572

30th May 2006

Daliah Barrett
Environmental Control Service
Civic Centre
Wood Green
London
N22 8LE

Dear Ms Barrett

Extension of late night premises licence: Yayla, 429 Green Lanes, London N4 1HA
Applying for extension on Friday and Saturday until 4.00am on the following day as
late night café and take-away

In response to and in support of residents, neighbourhood watch groups and resident's associations concerns, I am writing to you to oppose this application. There are a number of reasons why I feel this application should be refused:-

1. I believe that granting this licence would be against the general principles of Haringey's Licensing Policy and specifically with regard to the prevention of crime and disorder, public safety and the prevention of public nuisance.
2. This premises has repeated applied for and been refused permission for very late hours by the Planning Department on the grounds of loss of amenity to local residents and the surrounding area (including noise, disturbance, parking problems and of course refuse collection). I believe that all these reasons are still very much applicable and that permission should continue to be denied.
3. I believe that increasing the opening hours would lead to more anti-social behaviour and more crime.
4. Longer opening hours is likely to create noise nuisance to local residents and increase in the level of litter.
5. I feel that granting this application would set a precedent and lead to a flood of similar applications which would not be in the interest of the local area.

In conclusion I would urge the Licensing Sub-committee to reject this application and maintain the existing hours of 2am closing for Friday and Saturday nights.

Yours sincerely

A handwritten signature in cursive script that reads "Karen Alexander".

Karen Alexander

LADDER COMMUNITY SAFETY PARTNERSHIP

Incorporating the Are You Sure? campaign.

P.O. Box 32109 London N4 1GN

Telephone: 07931 761 558

...keeping crime off

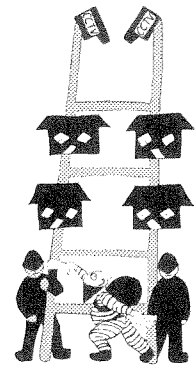

the "Ladder"

Daliah Barrett
Environmental Control Service
Civic Centre
Wood Green
London N22 8LE

25 May 2006

Dear Ms Barrett

**Extension of late-night premises licence: Yayla 429 Green Lanes, N4 1HA
Applying for extension on Friday & Saturday until 4.00 on the following day
as late-night café and take-away**

1 INTRODUCTION

The Ladder Community Safety Partnership (LCSP) contains representatives of Neighbourhood Watches and Residents' Associations from the 'Ladder' roads, adjacent to Green Lanes, Harringay and from Green Lanes itself. We are an independent group, although working in partnership with Haringey Council and the Metropolitan Police where appropriate.

We are writing to you as members of the LCSP to oppose this application.

We believe that in the context of the well known problems in the area, granting a licence for the hours requested would be against the general principles of Haringey's Licencing Policy and specifically under the following headings:

- **The Prevention of Crime and Disorder**
- **Public Safety**
- **Prevention of Public Nuisance**

More information on why we believe the Committee should reject this application is provided under appropriate headings below.

2 PLANNING CONSIDERATIONS

We fully understand that Licensing and Planning are deemed to be two separate but parallel regimes. However it is relevant to note that this premises has repeatedly sought planning permission for very late hours, which has been consistently refused by the Planning service on the grounds of loss of amenity to local residents and the surrounding area (eg noise, local disturbance, parking stress, refuse and rubbish collection etc). It is highly significant that these reasons for refusal under planning law are identical to the criteria for **the prevention of public nuisance** under the new licensing legislation.

Recent Planning history of the premises:

- in 2002, 05.00 daily was refused
- in 2004, 02.00 daily was refused (HGY/2004/1432)
- in 2005, 01.45 (Mon-Sat) and 01.00 (Sun) was refused (HGY/2005/0064)
- finally permission was granted on 8th March 2005 as follows
09.00 -00.00 (Sun-Thurs) and 10.00-02.00 (Fri&Sat) (HGY/2005/0064, amended),
(copy attached)

3 REASONS FOR OBJECTING

(a) Relevant sections of the Borough's Licensing Policy/Objectives

We believe the following statements in the Borough's Licensing Policy support our objections:

- *'the Council considers that licensing law plays a key role in both preventing and controlling ... anti-social behaviour ... by regulating and applying conditions to affect the number, location and hours of premises'* [2.4]
- *'the council will have special regard to the local impact of licensing on related crime and disorder ... particularly when concerning location, impact, operation and management of all proposed licenses, applications, renewals and variations of conditions'* [7.14]
- *'licensed premises, especially those operating late at night and in the early hours of the morning, can cause a wide range of nuisances that can impact on the people living, working or sleeping in the vicinity of the licensed premises. The Council is committed to protecting the residents in the vicinity of these licensed premises.'* [13.1]
- *'in particular, late night activities cause much of this nuisance. Late night cafes ... can have a number of adverse effects on the residents in the vicinity of these premises. Nuisance such as noise, litter, anti-social behaviour, lights and odour all contribute to the loss of amenity to the general public'* [13.2]
- *'the potential for additional crime and disorder and/or public nuisance is increased with longer hours.'* [18.1]
- *'operating hours between 23.00 and 07.00 are considered to give greater potential for*

noise nuisance [18.3]

(b) Licensing Hours

In the light of the above statements, we believe that in this case extending the hours until 04.00am on Friday and Saturday nights is totally unreasonable and contrary to the principles of the Borough's Licensing Policy and to the key Licensing Objectives.

We believe that granting of a permanent weekend licence for 20 hour opening is an unreasonable proposition, given the location of the premises in the heart of one of the most densely populated residential areas in the borough.

(c) The Prevention of Crime and Disorder

We have seen the brief comments relating to the prevention of crime and disorder put forward by the applicant. These seem inadequate and residents would also like to highlight the following points:

- has the use of CCTV to prevent crime and disorder been considered?
- are there policies/methods to deal with the arrival of intoxicated patrons and/or persons under the influence of illegal drugs?
- are patrons prevented from drinking alcohol brought onto the premises?
- are there procedures to deal with violence and anti-social behaviour?
- what methods are in place to discourage the handling of stolen goods etc?
- what methods are in place to address prostitution at the premises? (a particular problem on Green Lanes: Met. Police Taskforce 4 reported to the Green Lanes Strategy Group on 8 Sept 2005 that this was currently a serious concern with 5 prostitutes cautioned during the previous week)

(d) Public Safety

We are pleased to note that the applicant states that '*appropriate fire safety procedures are in place, including fire extinguishers*'. However there is a need for greater clarification regarding various aspects of Public Safety as set out in Appendix 2(2) of the Licensing Policy:

- fire safety risk assessment?
- compliance with all relevant building control rules and regulations?
- arrangements for emergency situations, including evacuation?
- arrangement for the management, supervision and training of staff to ensure that these measures are known and implemented?

(e) Prevention of Public Nuisance

We welcome the statements made by the applicant regarding the prevention of public nuisance. However, some further questions remain unanswered, in particular:

- more detail regarding the steps taken, or proposed, to prevent disturbances by customers arriving at, or leaving, the premises? (the Policy states that '*there will be*

greater responsibilities placed on premises operating between 23.00 and 07.00 than at other times of the day")

- the actions necessary to prevent disturbance from deliveries or collections at early or late hours, or staff cleaning up after closing time?
- the steps taken, or proposed, to prevent littering and fouling of public and open spaces - what specific measures are proposed by the business? This is particularly important as the premises also advertises a take-away service
- the arrangement for storage and disposal of trade waste - would the very long hours sought by the applicant lead to increased waste storage and disposal problems?
- the arrangements for cleansing and keeping clean the vicinity of the premises - this will include litter, refuse and other items originating from the premises and fouling caused by customers.

The Borough's Licensing Policy points out the special importance of these issues after 23.00 and in residential areas. (See Appendix 2(3) and 13.2).

3. CONCLUSION

We believe that the above points need to be clarified by the Licensing Committee and clearly specified in any licence granted

Our comments and objections obviously make clear that residents, who are supported by all of our Ward Councillors, are very concerned at the possible implications of a 20 hour licence at weekends for these premises. We would therefore urge the Licensing Sub-committee to reject this application and to maintain the existing hours of 2am closure for Friday and Saturday nights. This is necessary in order to uphold two of the key licensing objectives: the prevention of public nuisance and the prevention of crime and disorder.

Yours sincerely



on behalf of the LCSP

[Approved by the representatives of Neighbourhood Watches and Residents' Associations in the following Roads:]

Representation from Green Lanes and the following Roads:

Umfreville Road	Woollaston Road
Burgoyne Road	Cavendish Road
Pemberton Road	Warham Road
Seymour Road	Hewitt Road
Allison Road	Beresford Road
Effingham Road	Fairfax Road
Falkland Road	Lausanne Road
Hampden Road	Sydney Road

Environmental Services Directorate**Planning and Environmental Control Service**639 High Road, Tottenham, London, N17 8BD **Your ref:**

Tel: 020 8489 0000

Fax: 020 8489 5220

Minicom: 020 8489 5549

Date: 16/03/05**Our ref:** HGY/2005/0064**Contact:** Elizabeth Ennin-Gyasi**Telephone:** 020 84895126

Ladder Community Safety Partnership
PO Box 32109
LONDON
N4 1GN

Dear Sir/Madam

Town and Country Planning Act 1990**Town and Country Planning (General Development Procedure) Order 1995****Location:** 429 - 429A Green Lanes N4**Proposal:** Extension of opening hours from 08:00am - 23:30pm Sunday to Thursday to 09:00am to 12:00 midnight Sunday to Thursday and Friday to Saturday from 08:00am - 23:30pm to 10:00am to 02:00am.

With reference to the above planning application I am writing to inform you that after taking into consideration relevant planning policies and the comments of local residents the Council has on 08/03/2005, GRANTED planning permission subject to the following condition:

1. A suitable soundproofing scheme to provide effective resistance to the transmission of airborne and impact sound shall be submitted to, approved in writing by, and implemented in accordance with the requirements of the Local Planning Authority for all compartment floors and party walls prior to the operation of the approved extension of hours.

Reason: In order to ensure that the proposed conversion does not give rise to an unacceptable loss of amenity for occupiers within the property as a direct result of inadequate soundproofing.

REASONS FOR APPROVAL

It is considered that the extension of hours proposed in relation to this application is reasonable and should not unduly affect the amenities of the locality or the existing occupiers. Accordingly it is considered to comply with the following policies STC 2.4 'A3 Uses Food and Drink', DES 1.9 'Privacy and amenity of neighbours' and RIM 3.3 'Nuisance from existing uses and road traffic'. The application is therefore recommended for approval.

Thank you for showing an interest in this matter.

Yours faithfully

Paul Smith**Head of Development Control East**

DIRECTOR Peter Norton

ASSISTANT DIRECTOR - PLANNING, ENVIRONMENTAL POLICY & PERFORMANCE Shifa Mustafa

DECGE
Informing of decision
East Team